

via Brezze a Sant'Erasmus

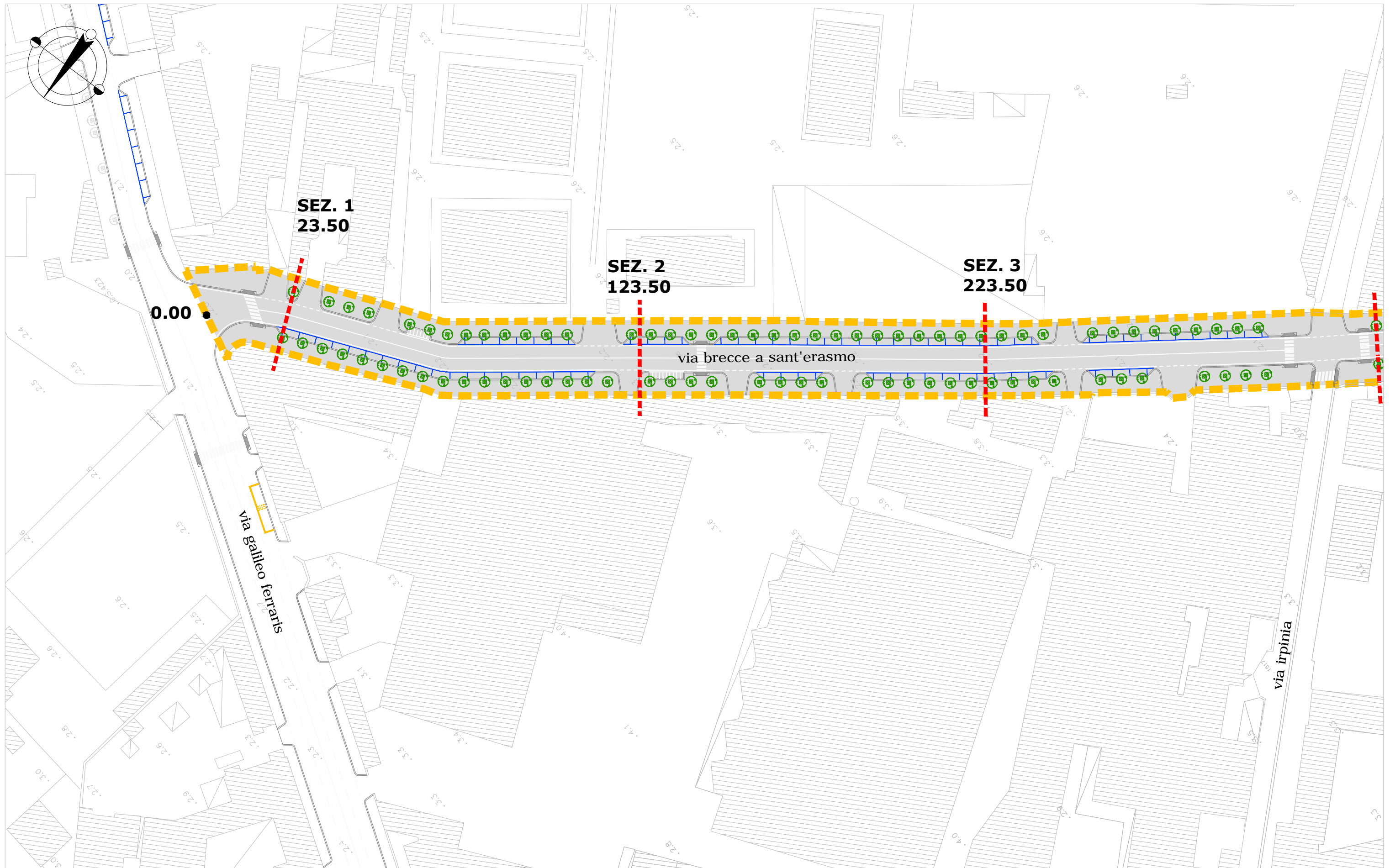

Via Brece a Sant'Erasmus, tratta via Galileo Ferraris/via Irpinia - planimetria scala 1:1000

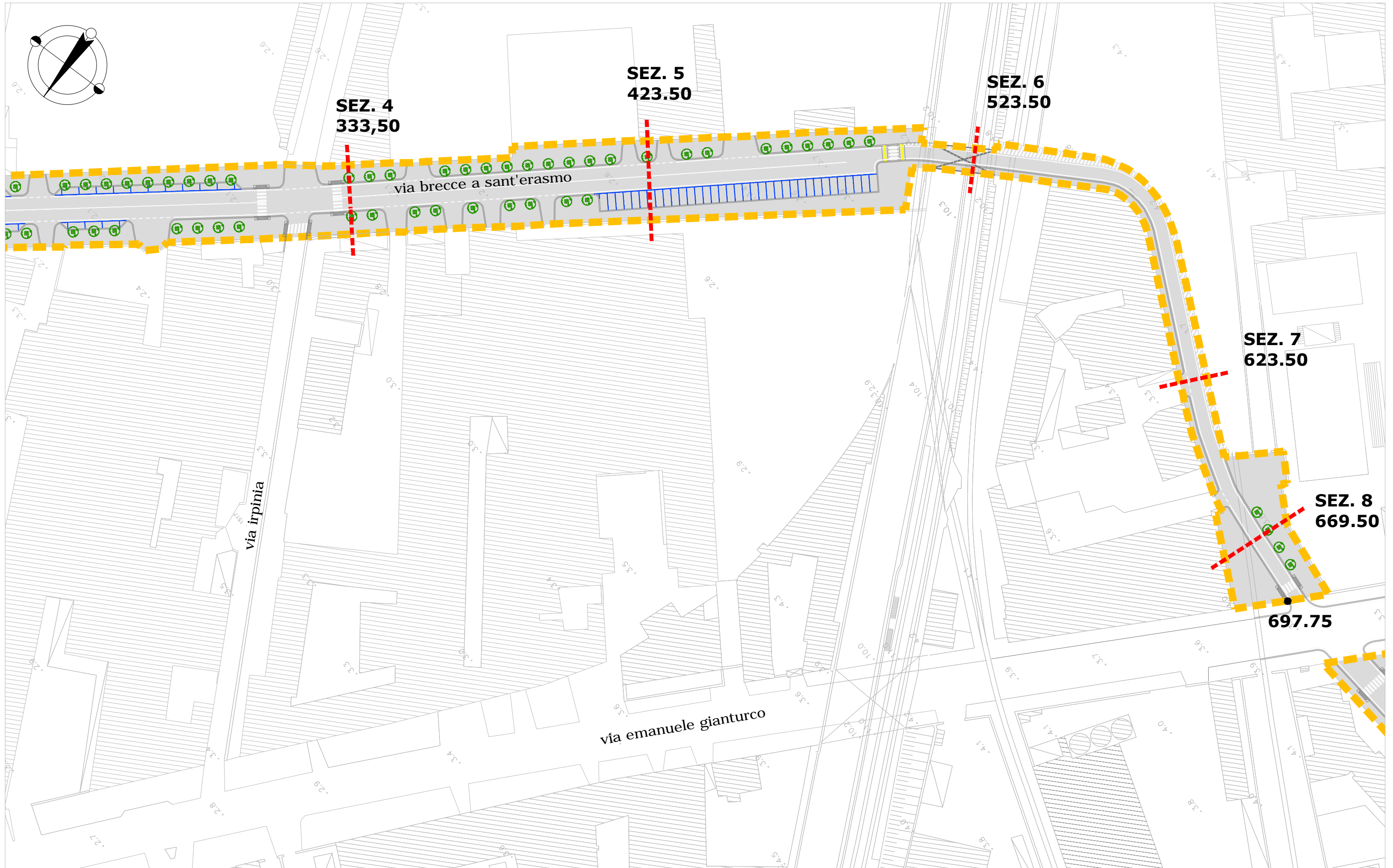

Via Brece a Sant'Erasmus, tratta via Irpinia/via Emanuele Gianturco e via Irpinia - planimetria scala 1:1000

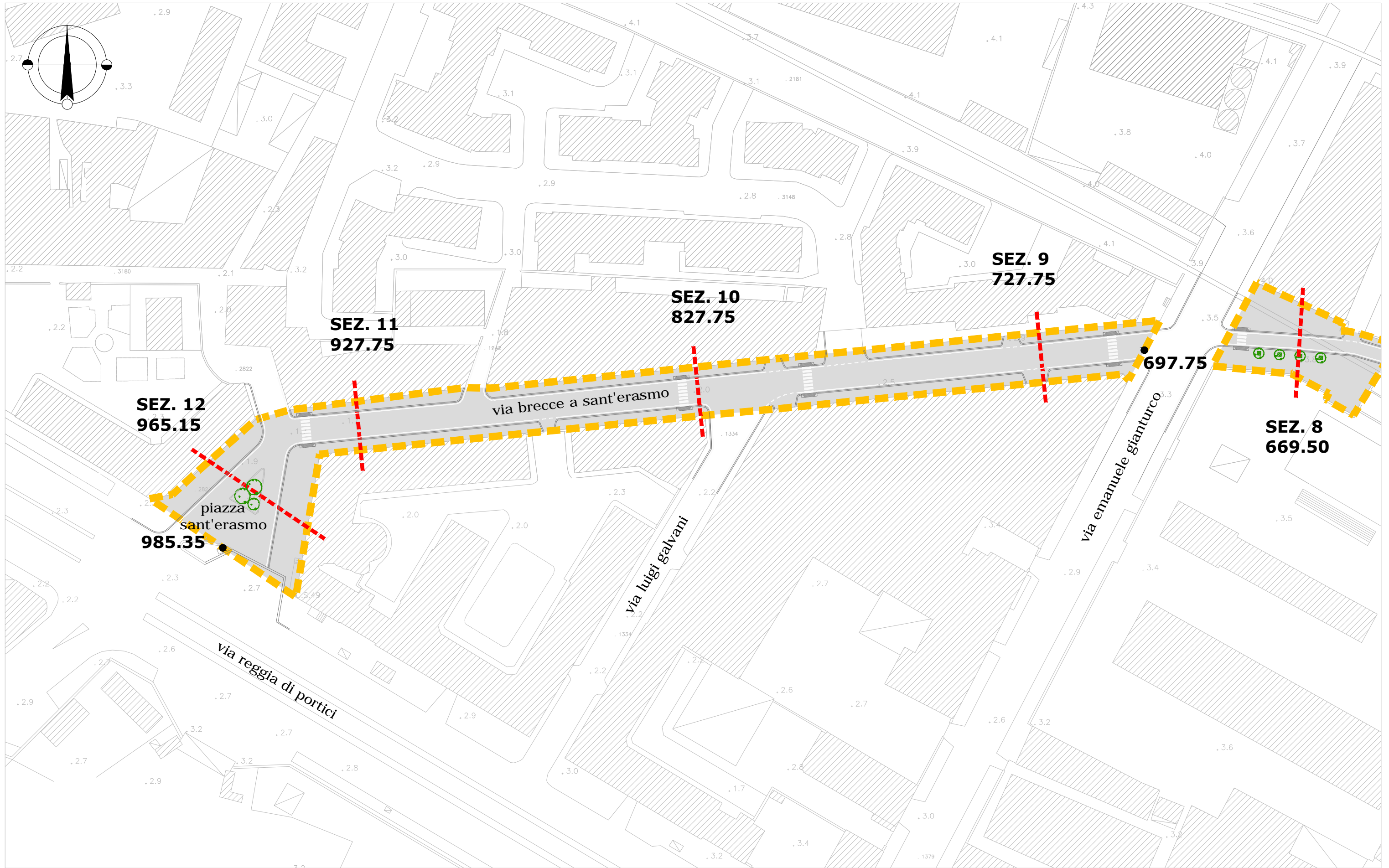

Via Brece a Sant'Erasmus, tratta via Emanuele Gianturco/piazza Sant'Erasmus - planimetria scala 1:1000



Via Brece a Sant'Erasmus, tratta via Galileo Ferraris/via Irpinia - scala 1:1000

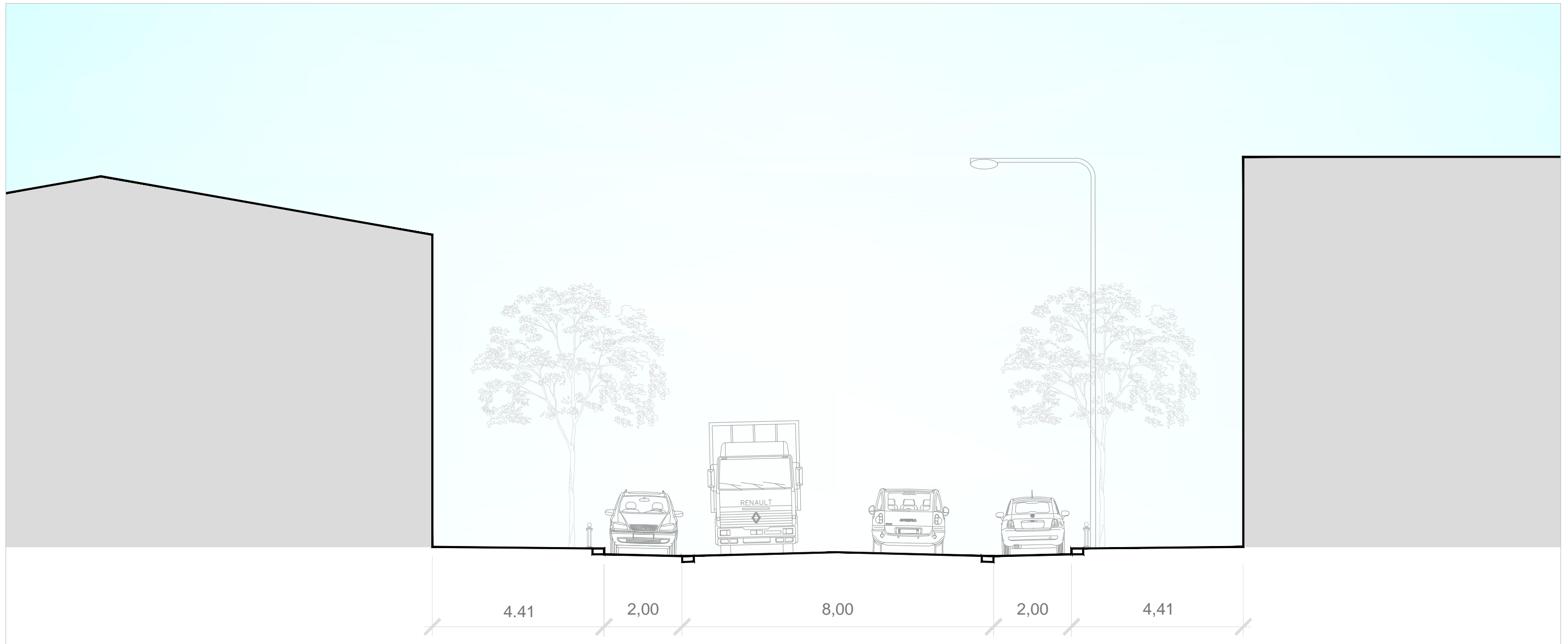

Via Brece a Sant'Erasmus, tratta via Galileo Ferraris/via Irpinia - SEZ. 3, scala 1:100

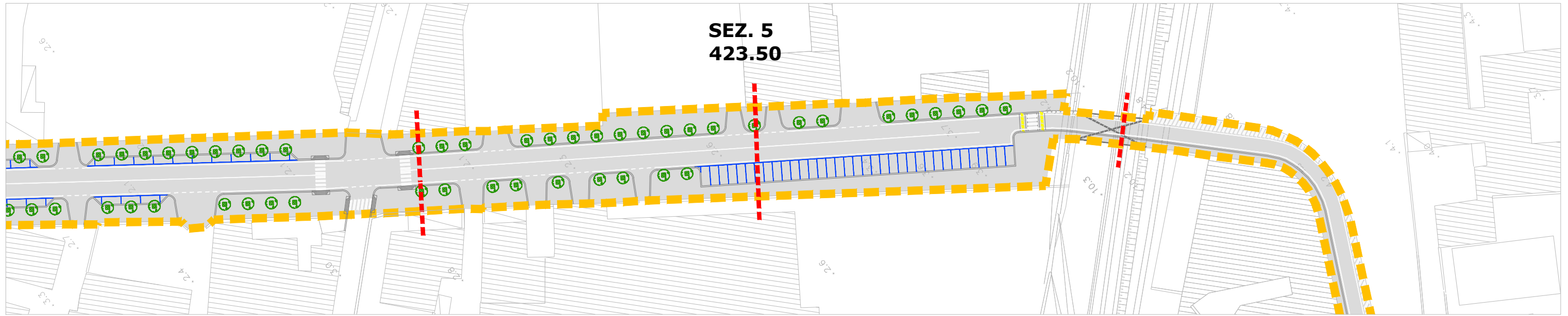

Via Brece a Sant'Erasmus, tratta via Irpinia/via Emanuele Gianturco - scala 1:1000



Via Brece a Sant'Erasmus, tratta via Irpinia/via Emanuele Gianturco - SEZ. 5, scala 1:100

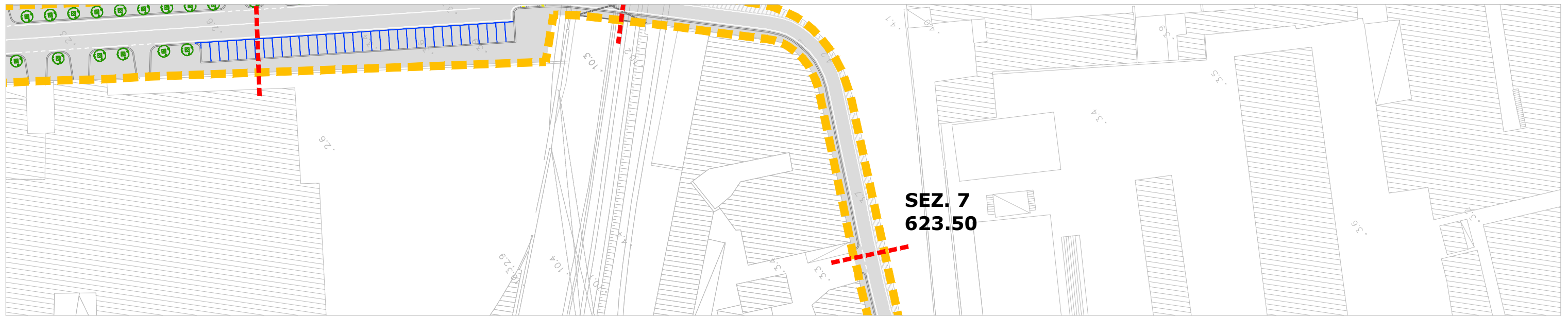

Via Brece a Sant'Erasmus, tratta via Irpinia/via Emanuele Gianturco - scala 1:1000

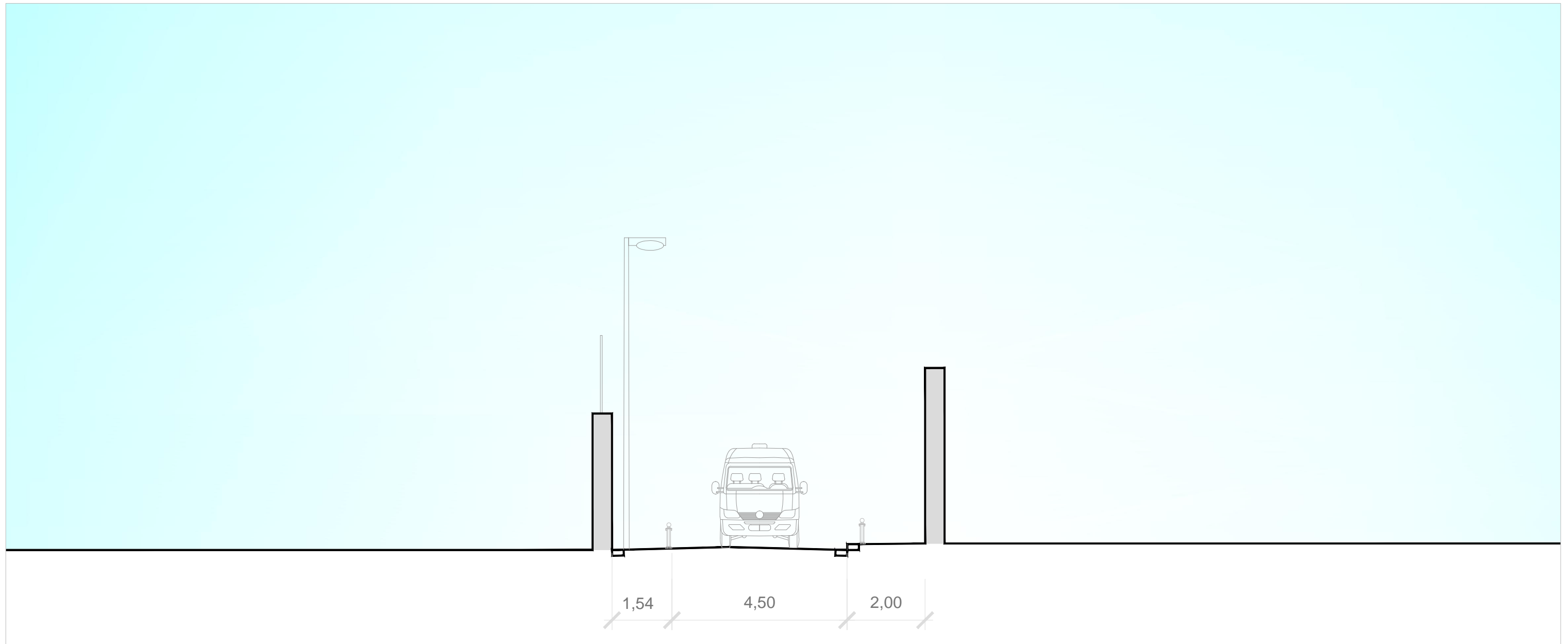

Via Brece a Sant'Erasmus, tratta via Irpinia/via Emanuele Gianturco - SEZ. 7, scala 1:100

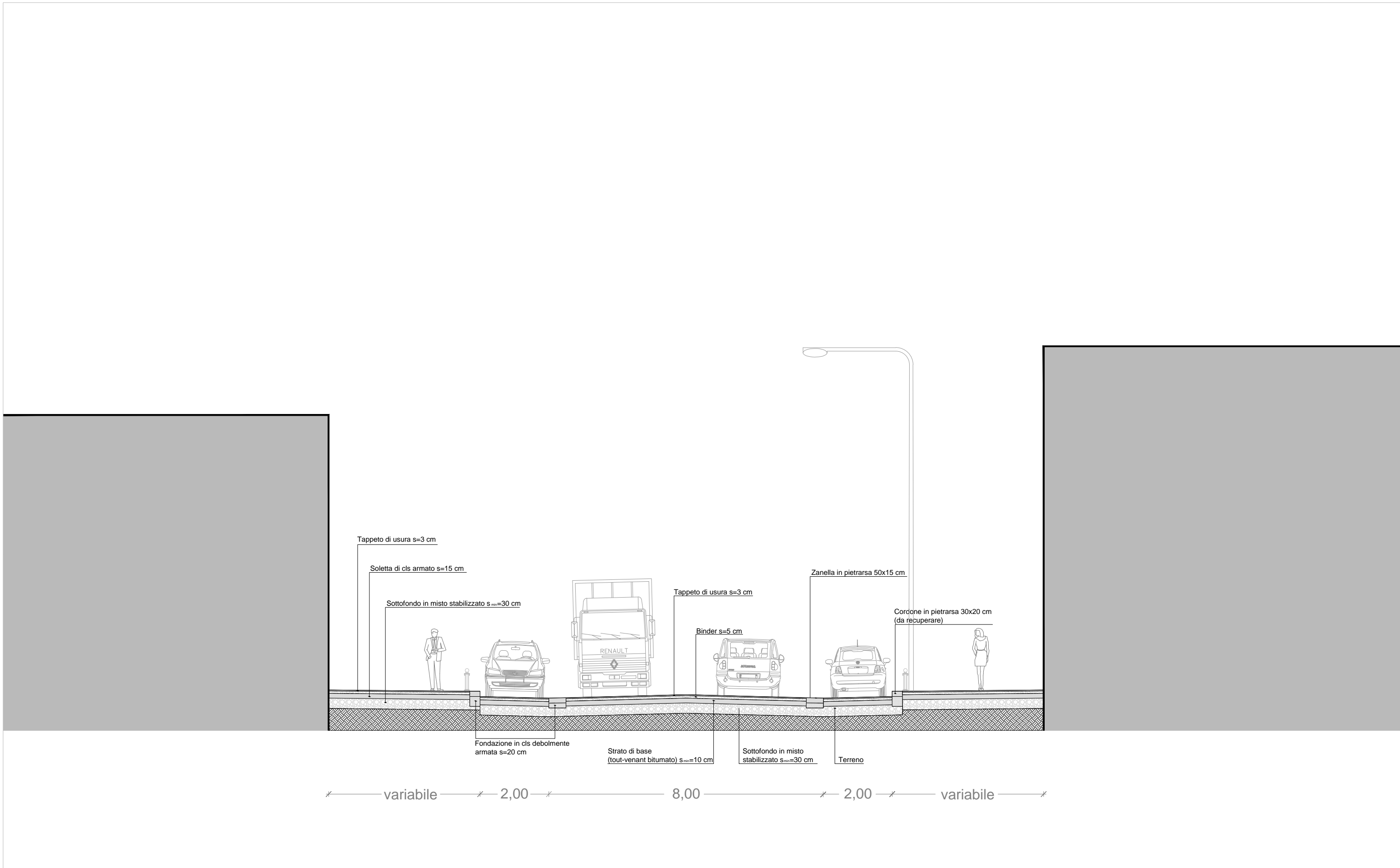

Via Brecece a Sant'Erasmo - sezione tipo, scala 1:100