



Comune di Napoli
IV MUNICIPALITA'

MERCATO DI NATALE 2011

CENTRO DIREZIONALE (1)
Prossimità Gruppo Catopano

TAV.
8

Legenda

-  3,00x3,00 - N. 8
-  3,00x3,00 - N. 10
-  2,50x2,50

Esposizione
Sette 1059

Funz. Tecn. Raffaele Romano
I.D.T. Ciro Miranda
I.T. Antonio Pallotta
I.A. Giuseppe Raimo

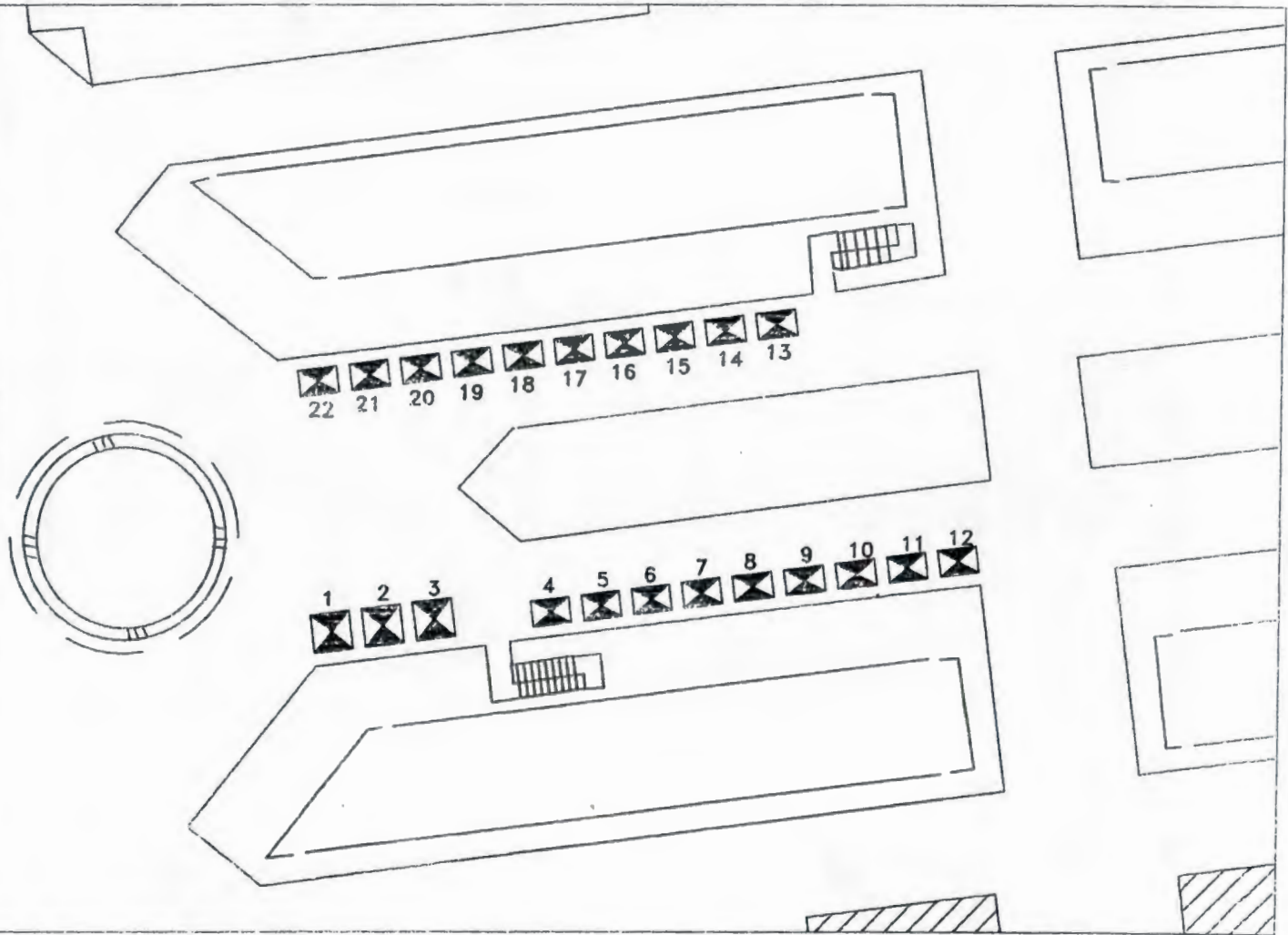



Comune di Napoli
IV MUNICIPALITA'

MERCATO DI NATALE 2011

CENTRO DIREZIONALE (2)
Prossimità Edificio TIM

TAV.
8

Legenda

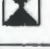
-  8,00€ - N. 18
-  8,00€ - N. 28
-  8,50€

Prossimità Edificio
Scala 1/200

Funz. Tecn. Raffaele Romanucci
L.D.T. Ciro Miranda
I.T. Antonio Palletta
I.A. Giuseppe Raimo

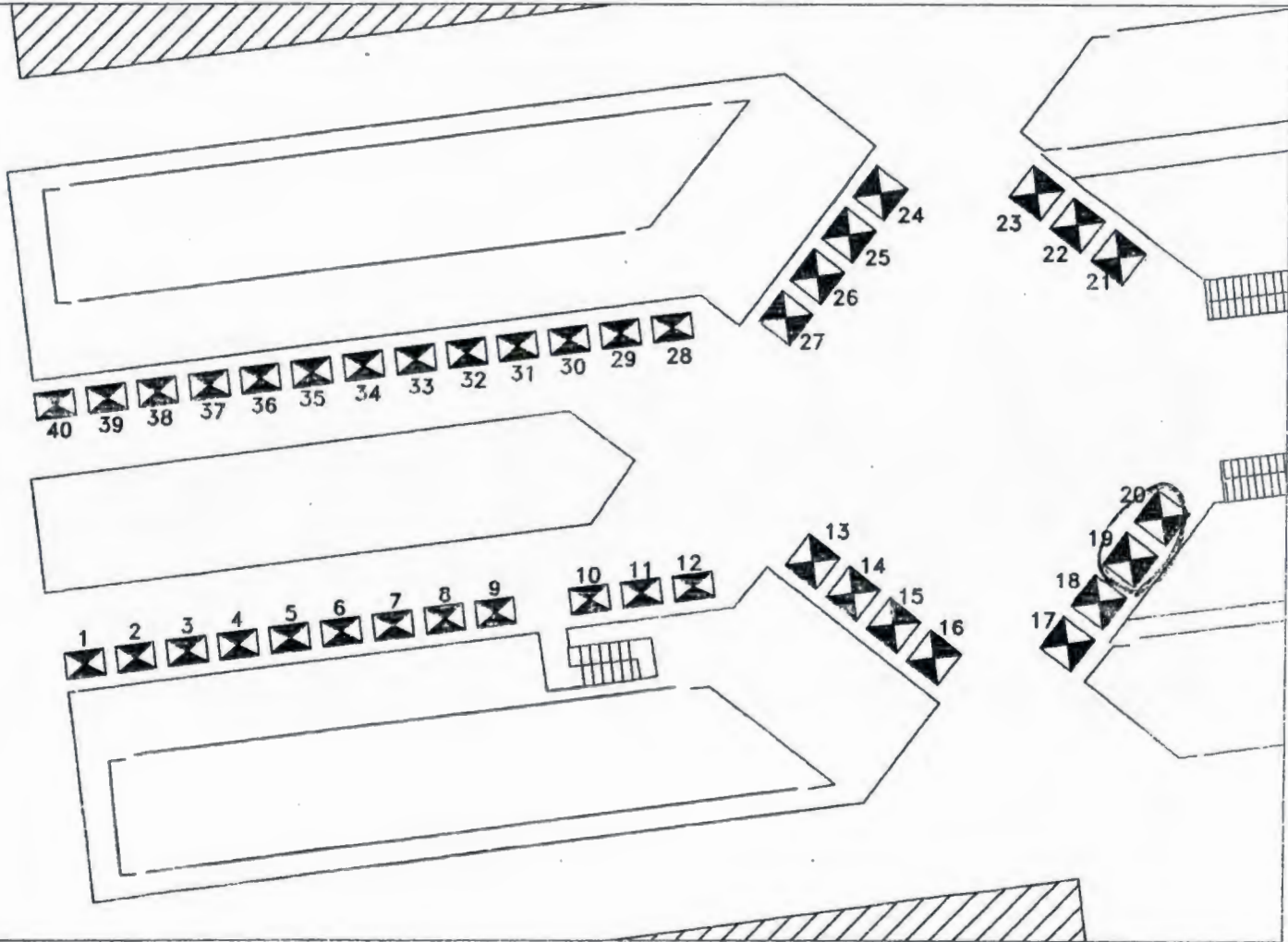

8

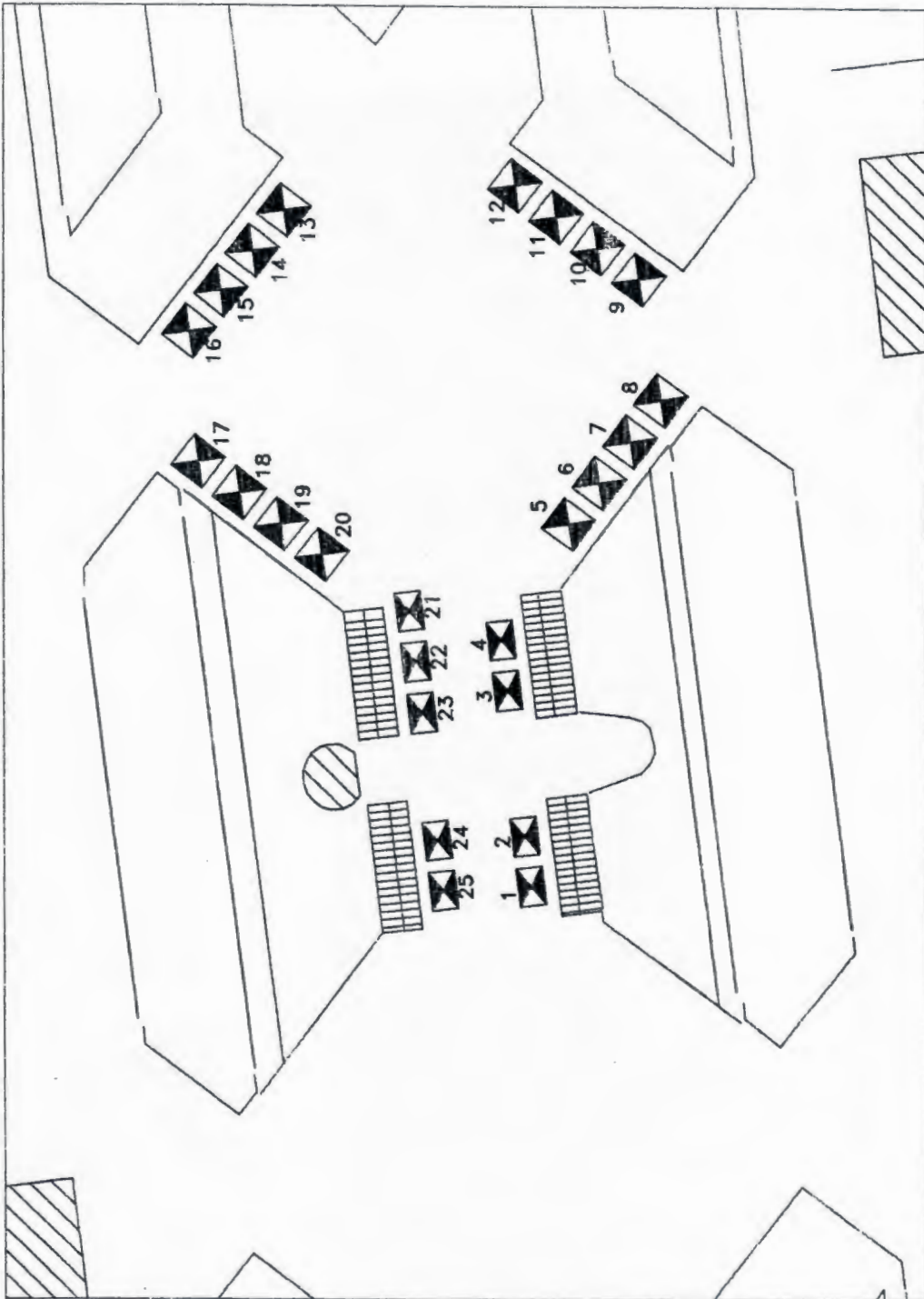

Comune di Napoli
IV MUNICIPALITA'

MERCATO DI NATALE 2011

CENTRO DIREZIONALE (3)
Prossimità "Bar Franco"

TAV. 4

Int. Impianto 12/11/10
Cada. 1/2010

Legenda

	0,0000,00 - N. 10
	0,0000,00 - N. 0
	0,0000,00

P.una.Tem. Raffaele Romanucci
I.D.T. Gino Miranda
I.T. Antonio Falotta
I.A. Giuseppe Raimo



Comune di Napoli
IV MUNICIPALITA'

MERCATO DI NATALE 2011

CENTRO DIREZIONALE (4)
Isola B/2

TAV.
5

Legenda

	0,00€0,00
	0,00€0,00 - N. 99
	0,00€0,00

Scala 1:200

Funz. Tecn. Raffaele Romanucci
I.D.T. Ciro Miranda
I.T. Antonio Pallotta
I.A. Giuseppe Raimo

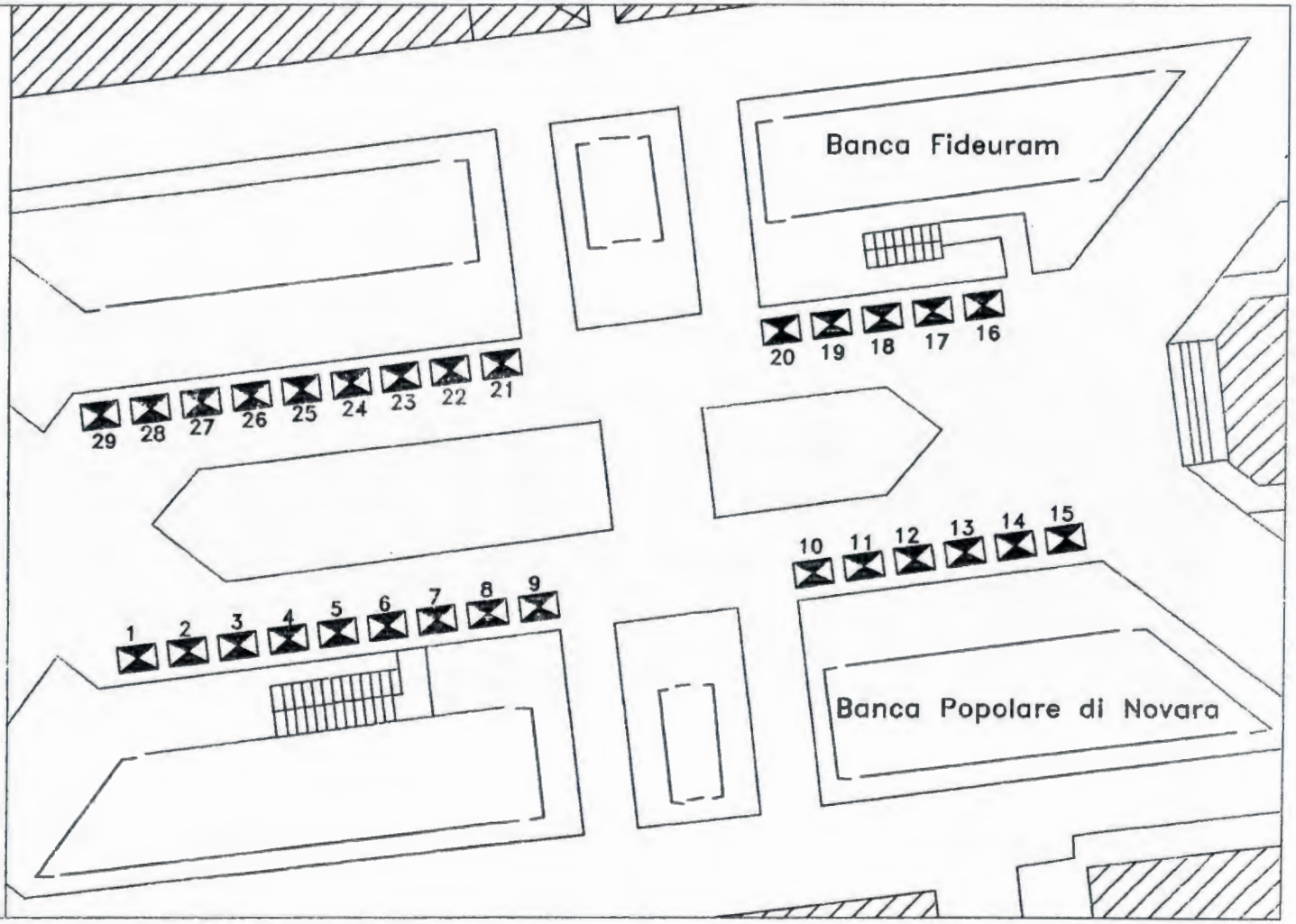



Comune di Napoli
IV MUNICIPALITA'

MERCATO DI NATALE 2011

CENTRO DIREZIONALE (5)
Prossimità Camera di Commercio

TAV.
6

Legenda

-  0,00m2,00 - N. 84
-  0,00m2,00
-  0,00m2,00

Int. 100m2
Scala 1:1000

Prinz. Tecn. Raffaele Romanucci
I.D.T. Ciro Miranda
I.T. Antonio Palotta
I.A. Giuseppe Balzo

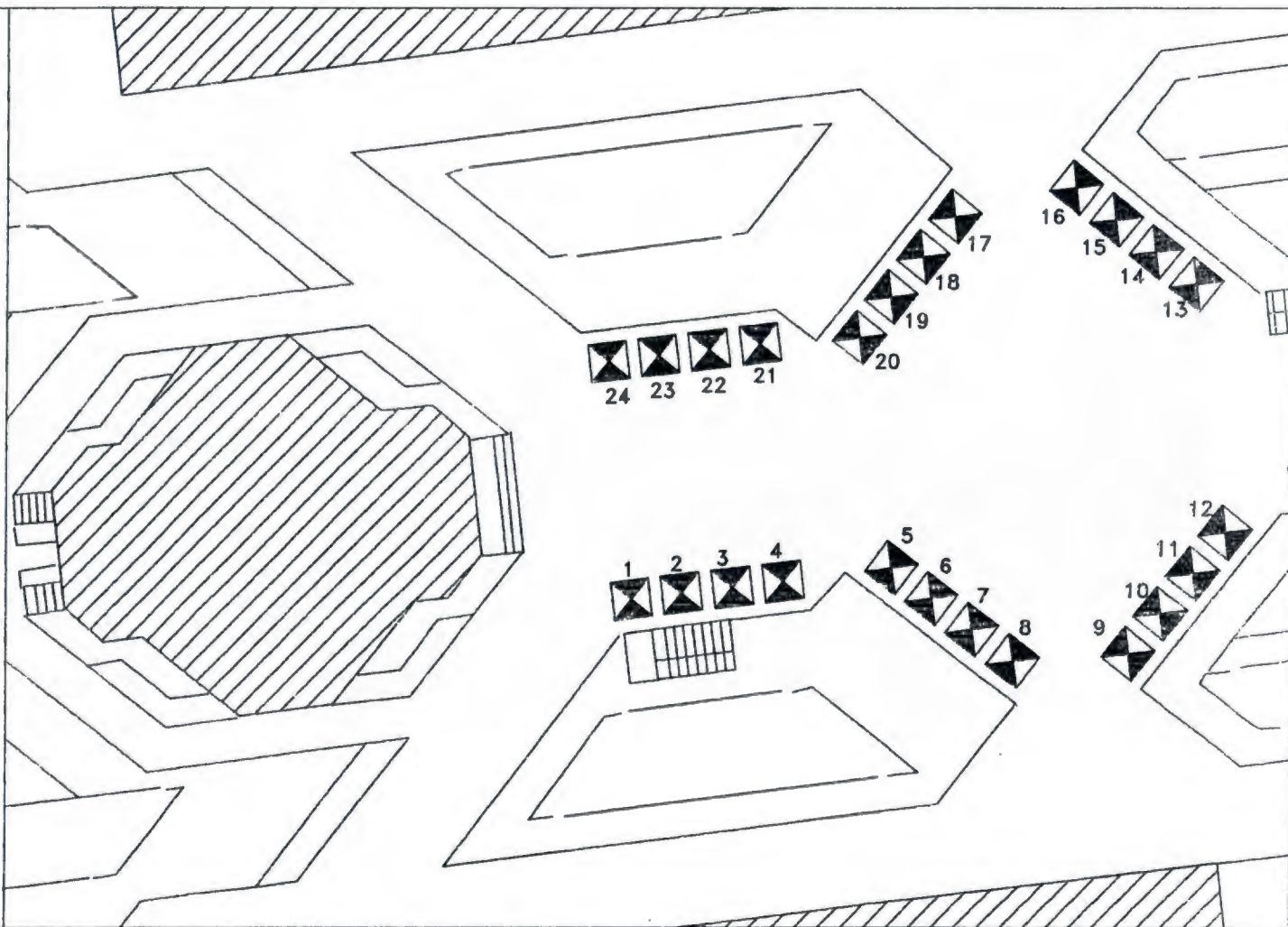

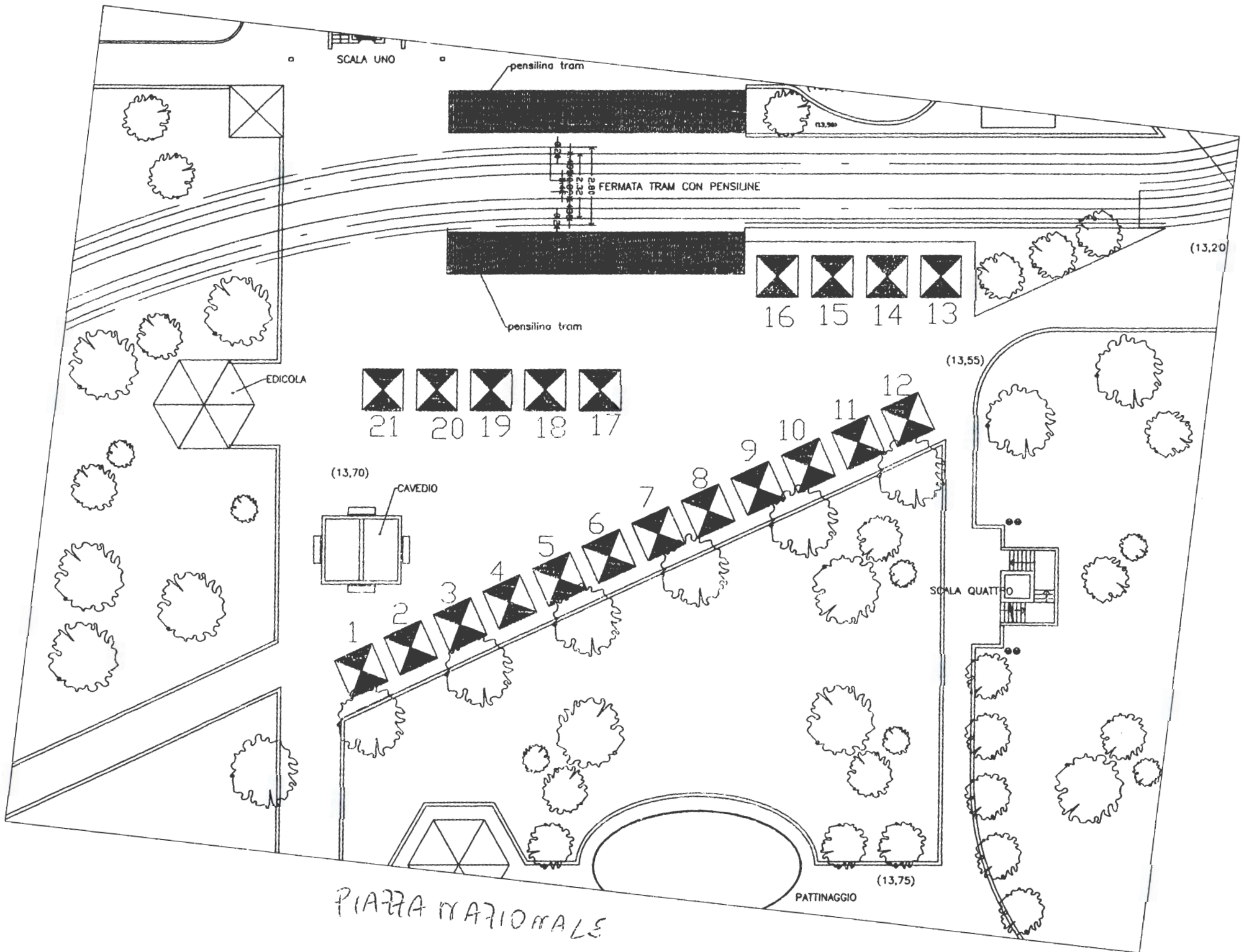

PIAZZA NAZIONALE

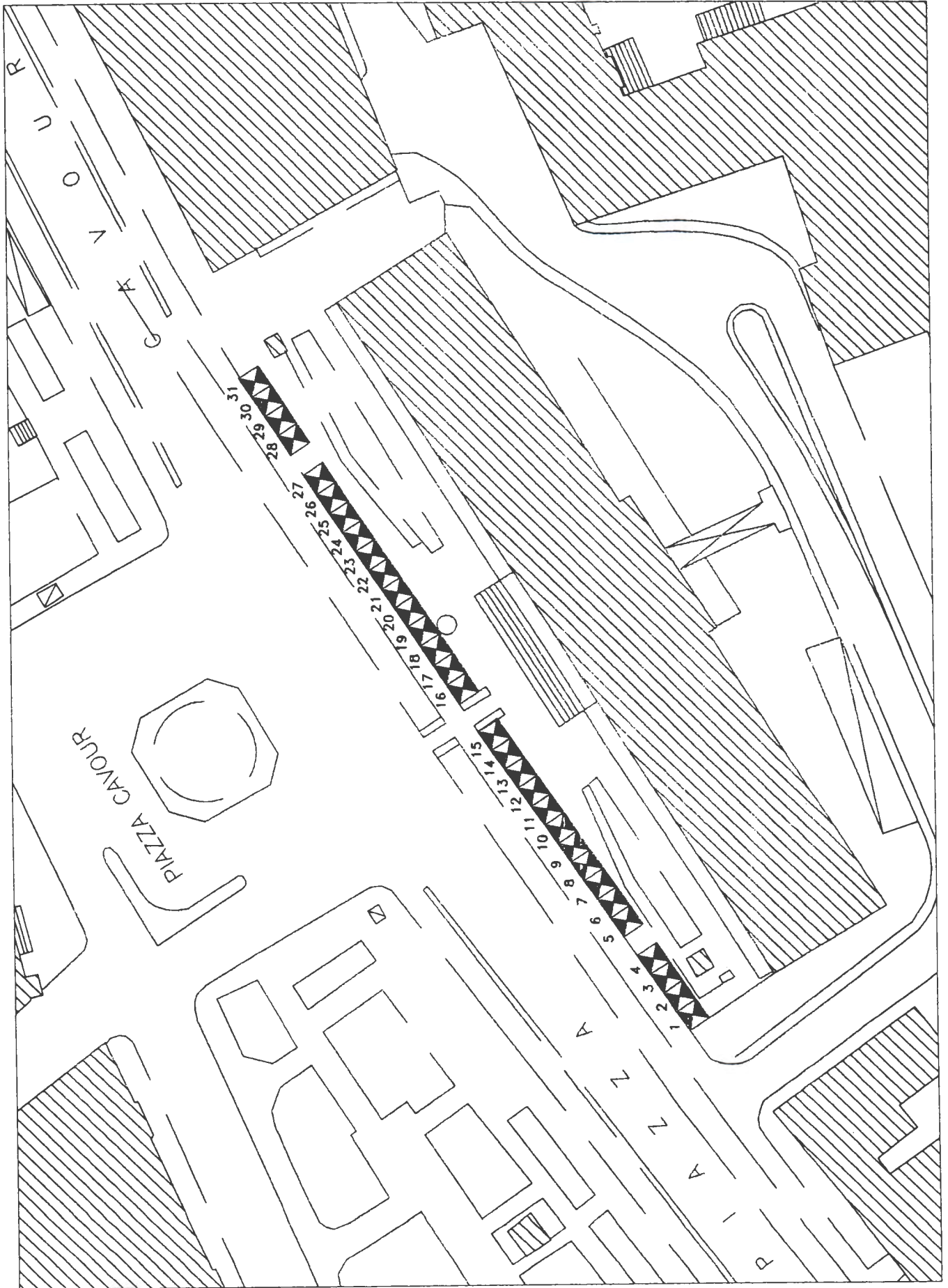

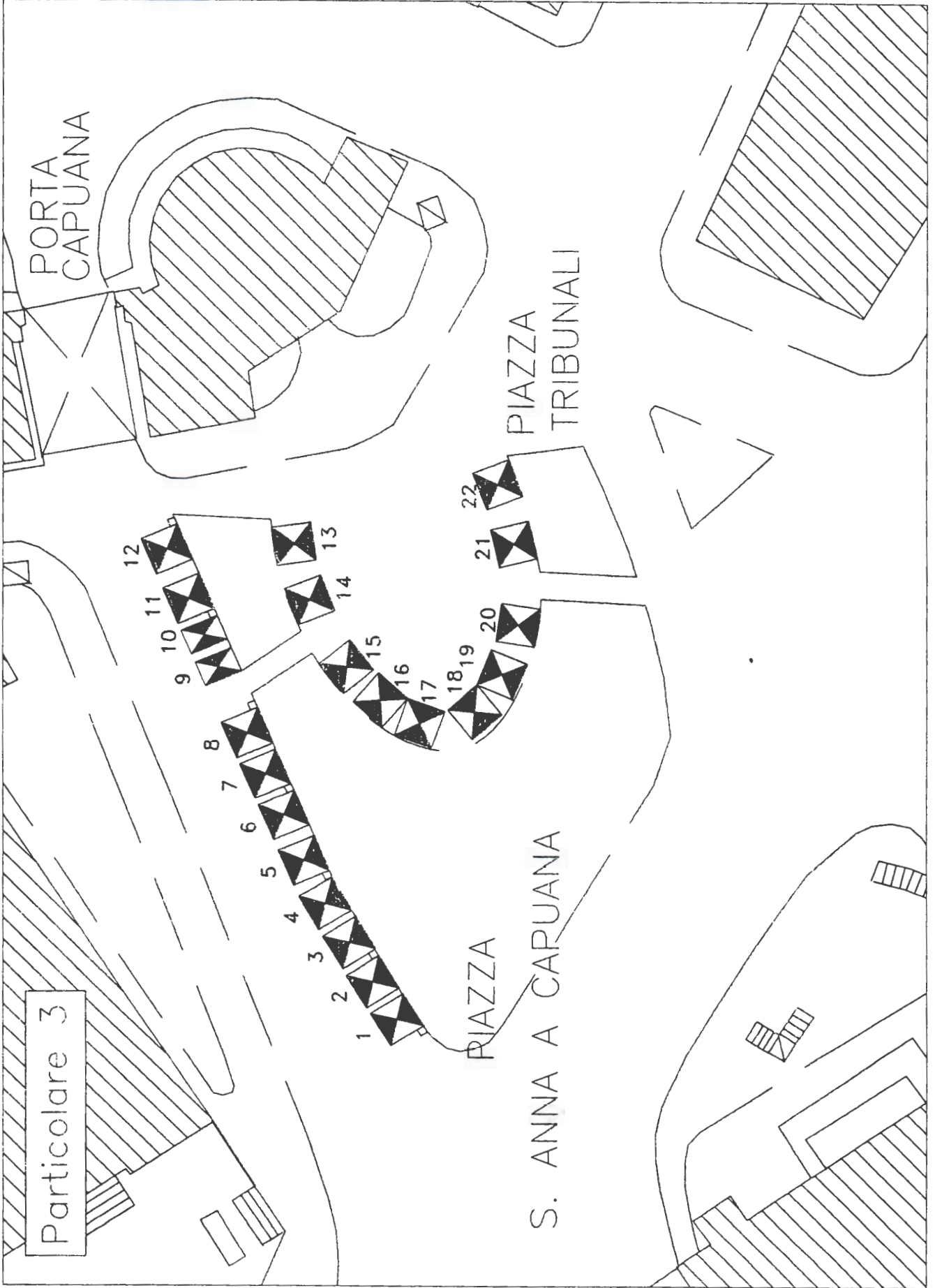

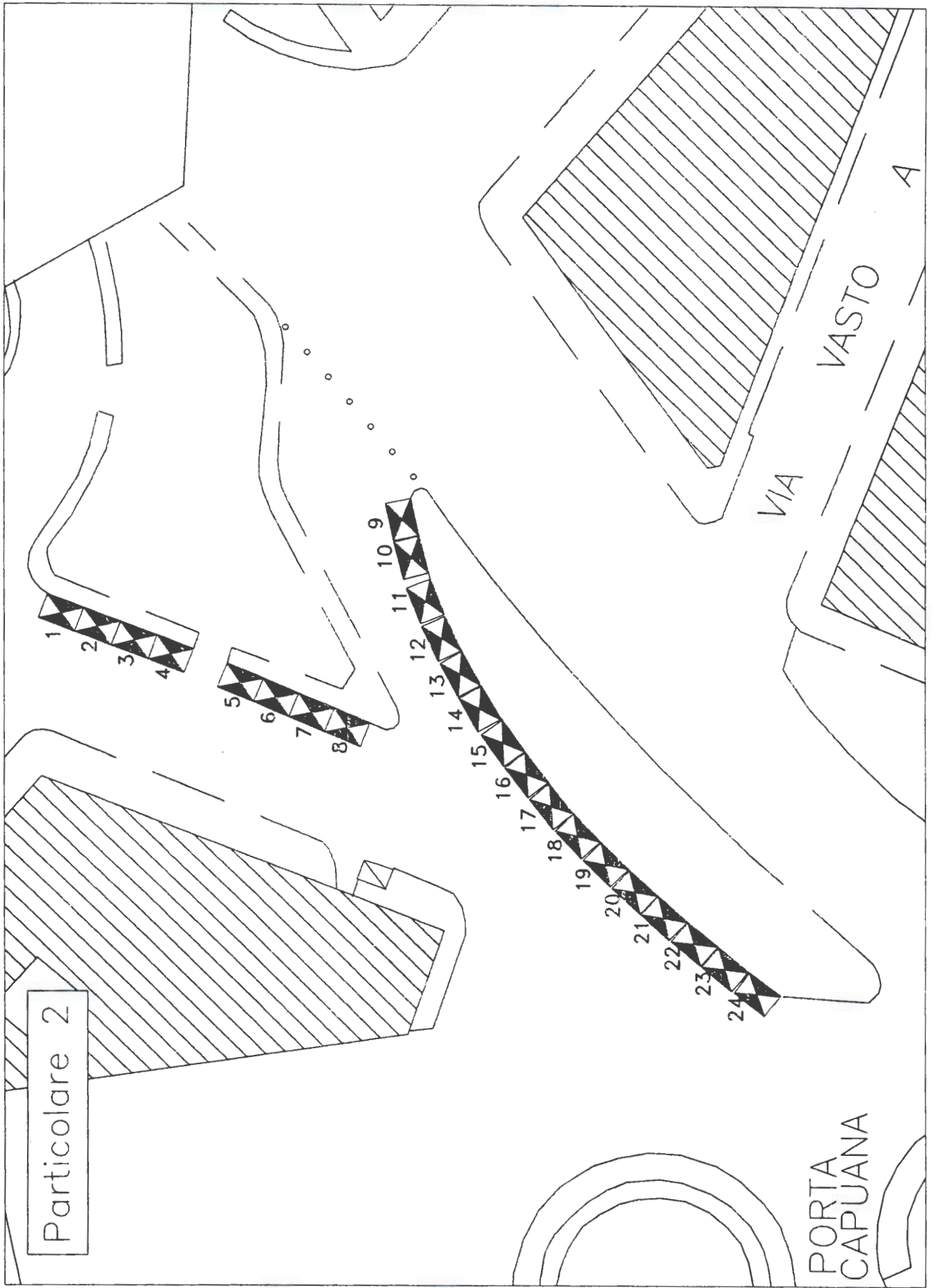

Particolare 2

PORTA
CAPUANA

VIA
VASTO

51

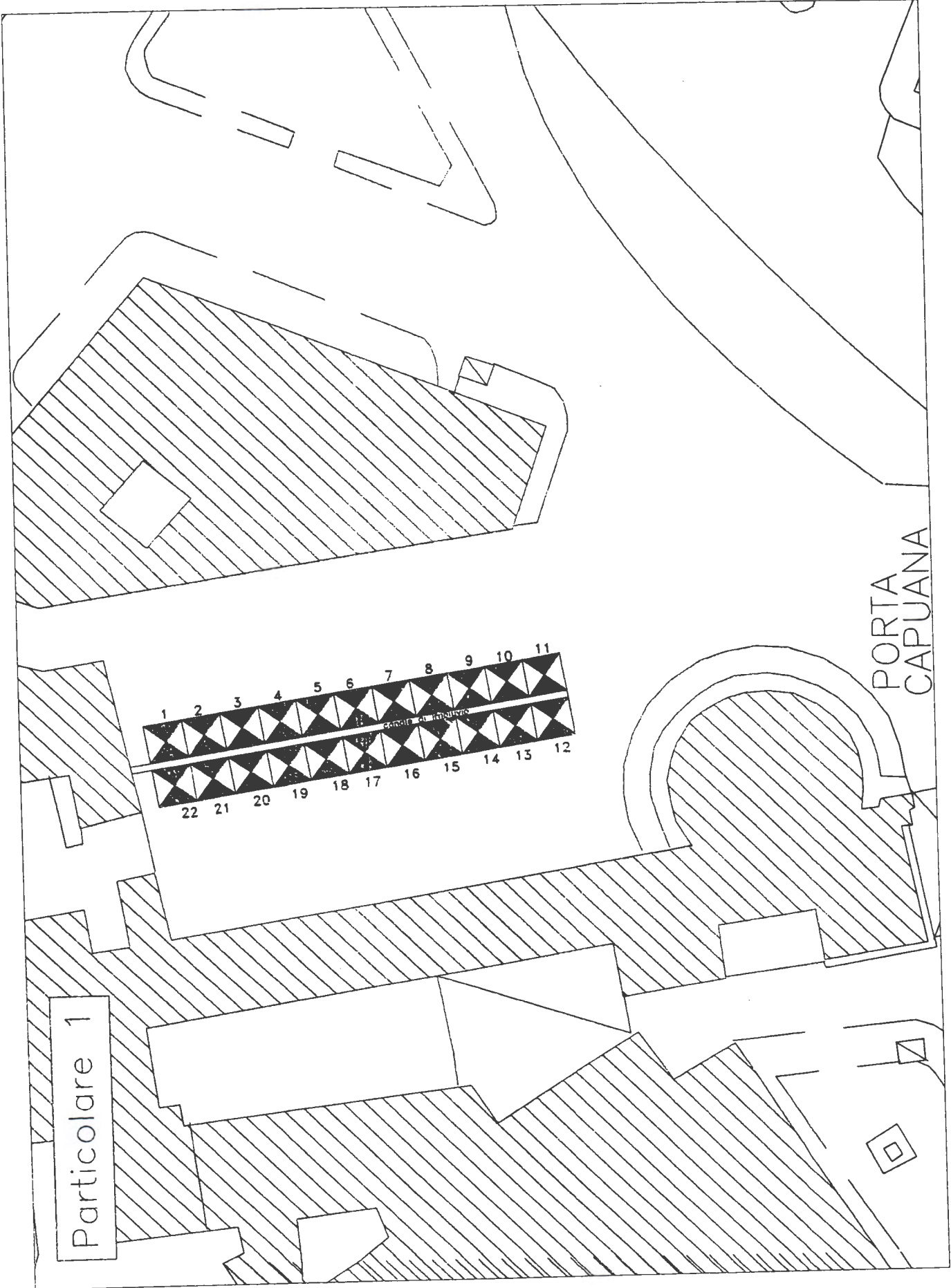

Particolare 1

PORTA
CAPUANA

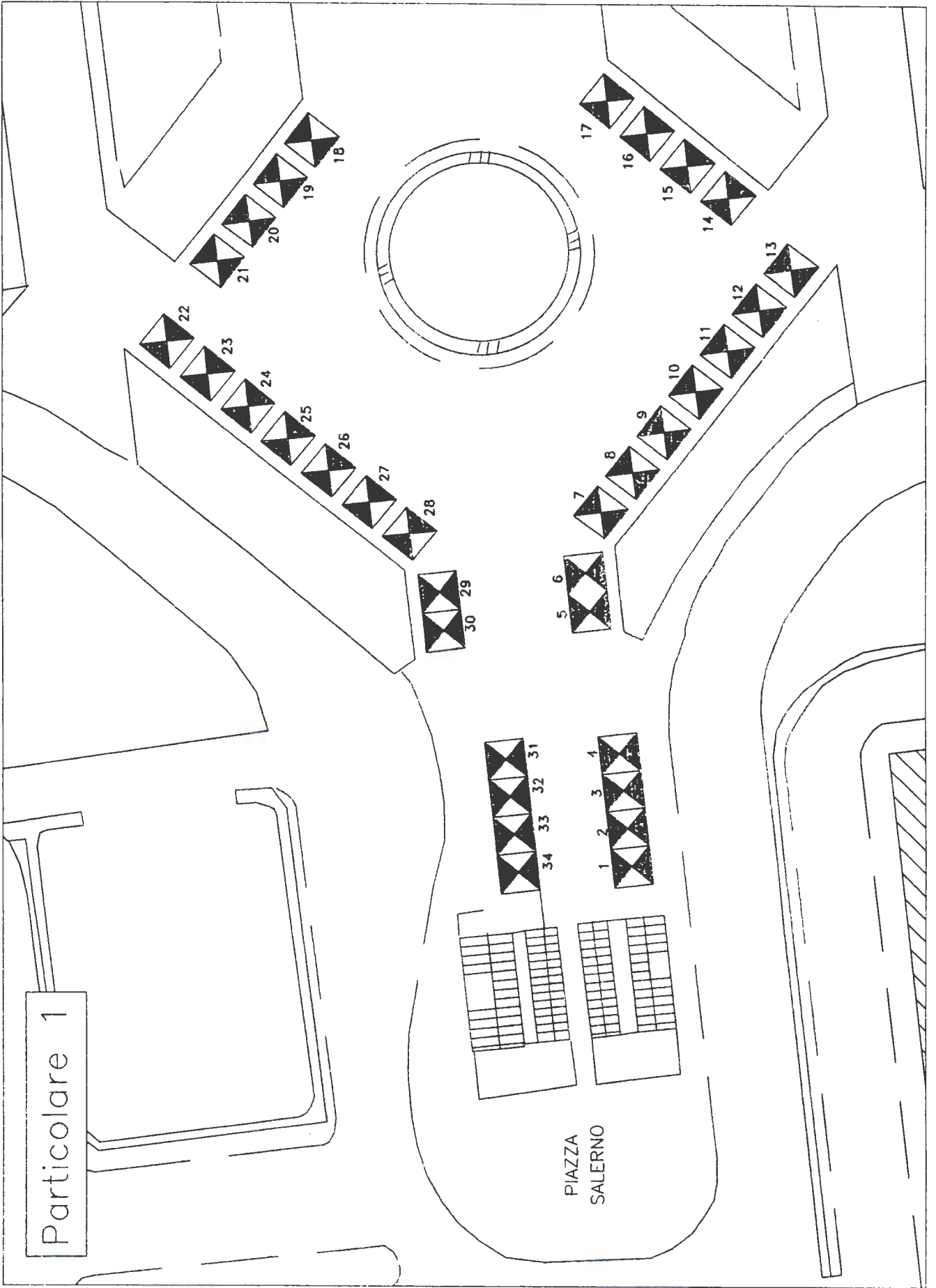

CENTRO DIREZIONALE 1- PIAZZA SALERNO

17



PIAZZA DEI GEROLOMINI

8/

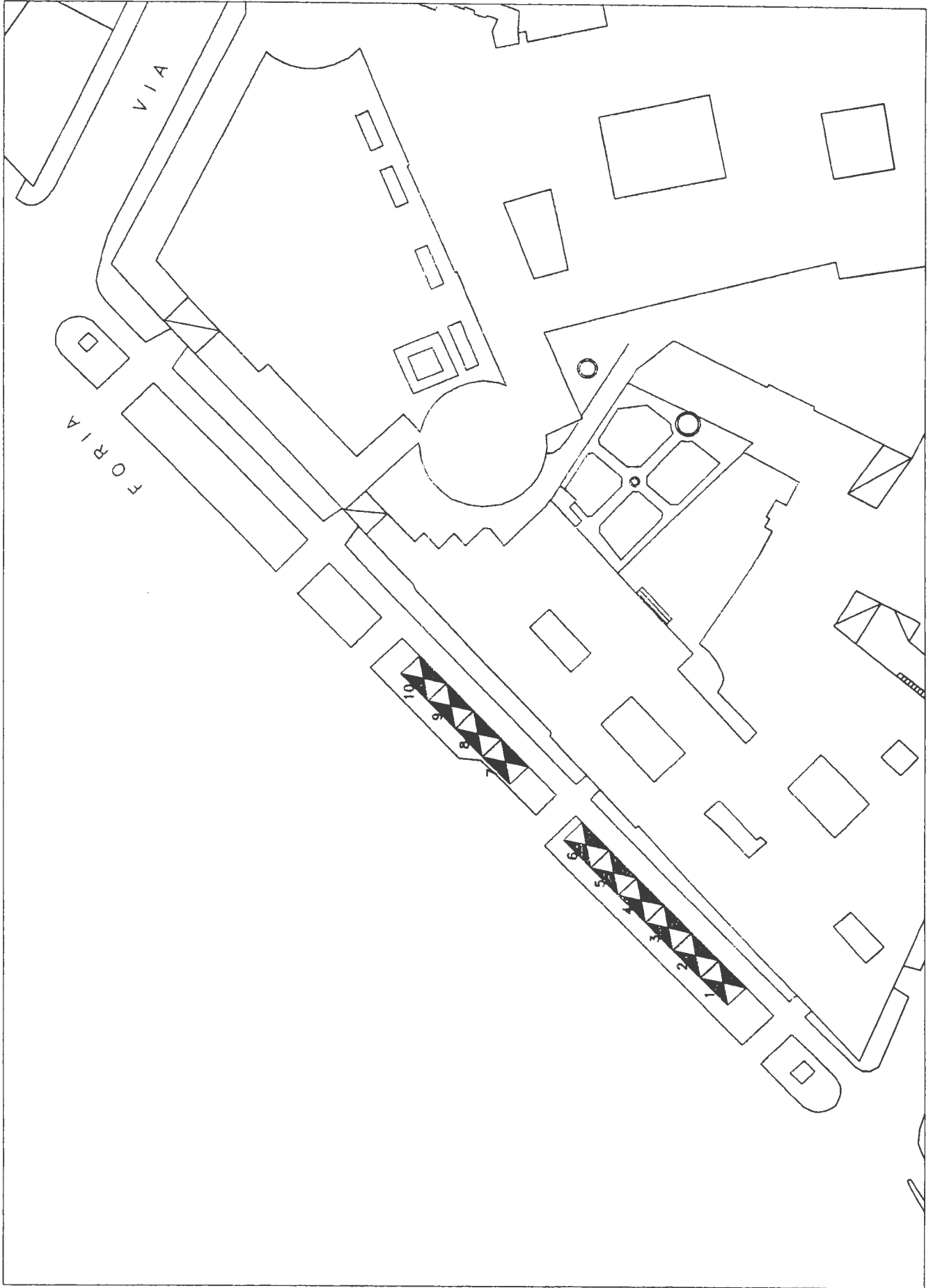

VIA FORIA

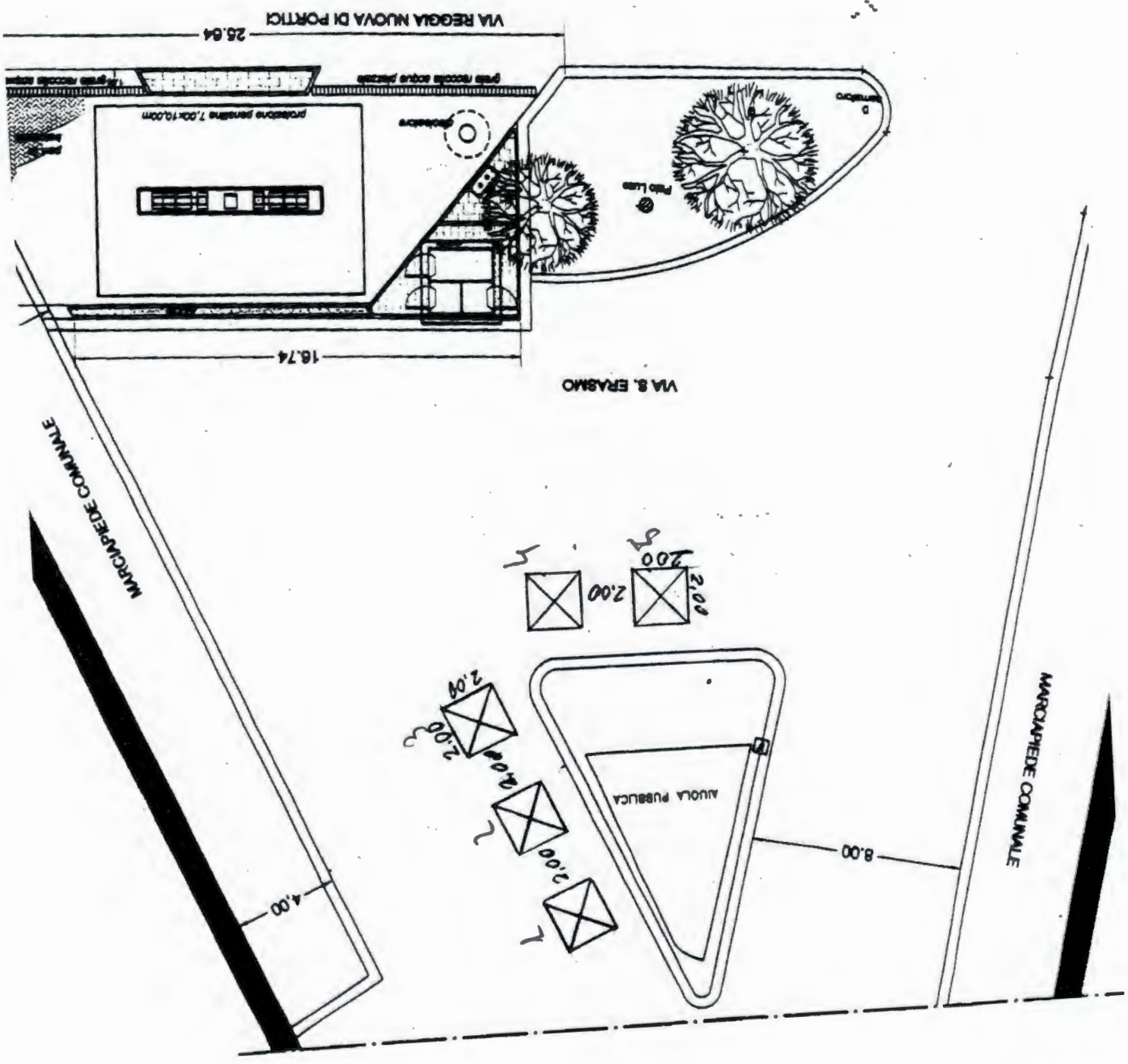

STATO FUTURO
SCALA 1:200

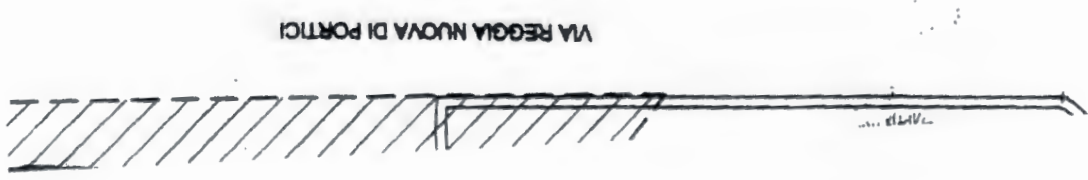

19

Piazza Poderico

(0,12m)

sey

(0,00m)

(0,12m)

(0,12m)

via Andrea Matteo Acquaviva

(0,00m)

(0,12m)

(0,12m)

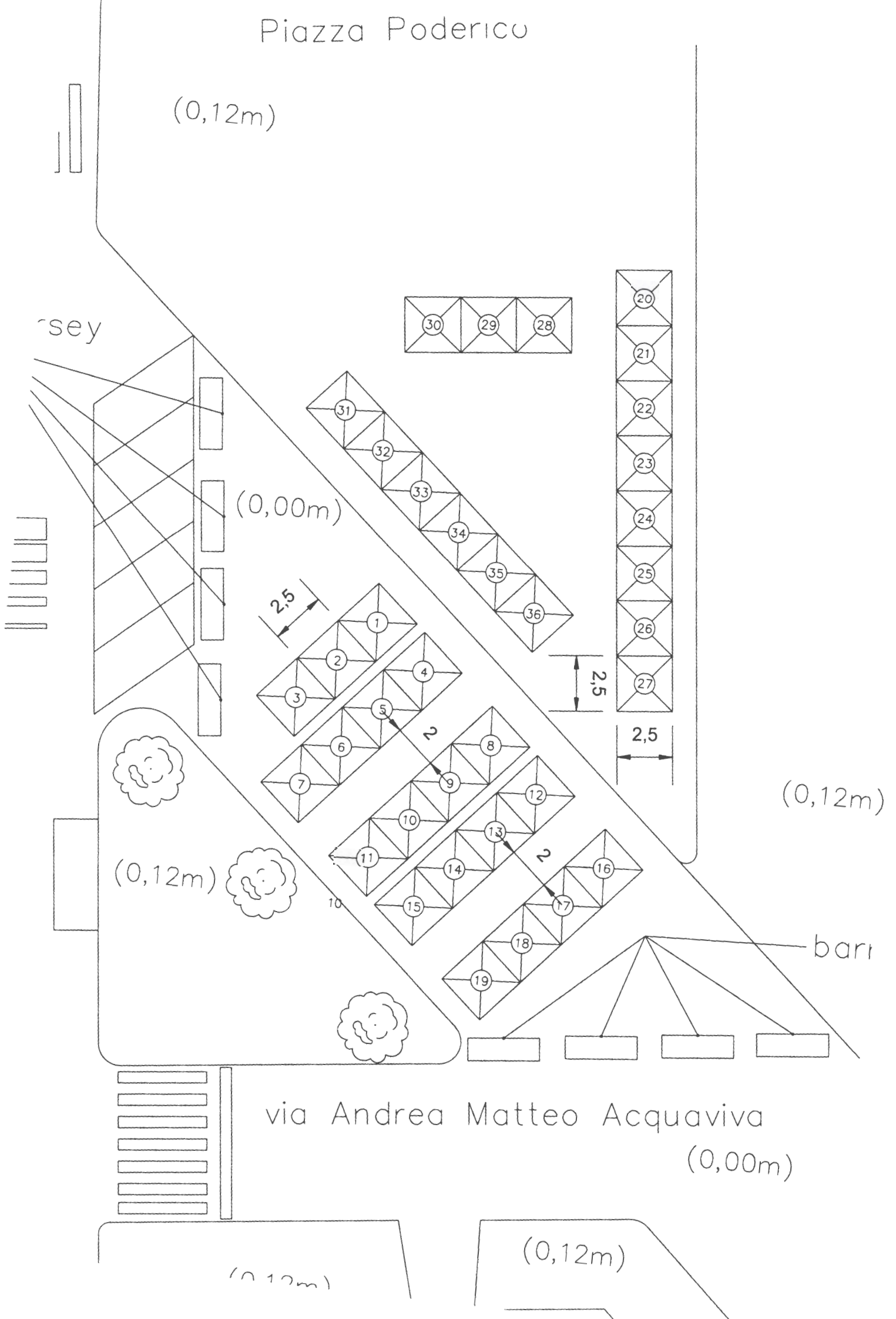

Mercato Caramanico
spazio da potere occupare 650 m²

